

# Mark Stephenson's

ESTATE & LETTING AGENTS



## 11 Plough Lane, Malton, YO17 7AP

£1,100

- Long term tenancy preferred
- Refitted dining size kitchen
- En-suite and family bathroom
- Highly popular location
- Downstairs WC
- Gas Central heating
- Off road parking for two
- Three bedrooms

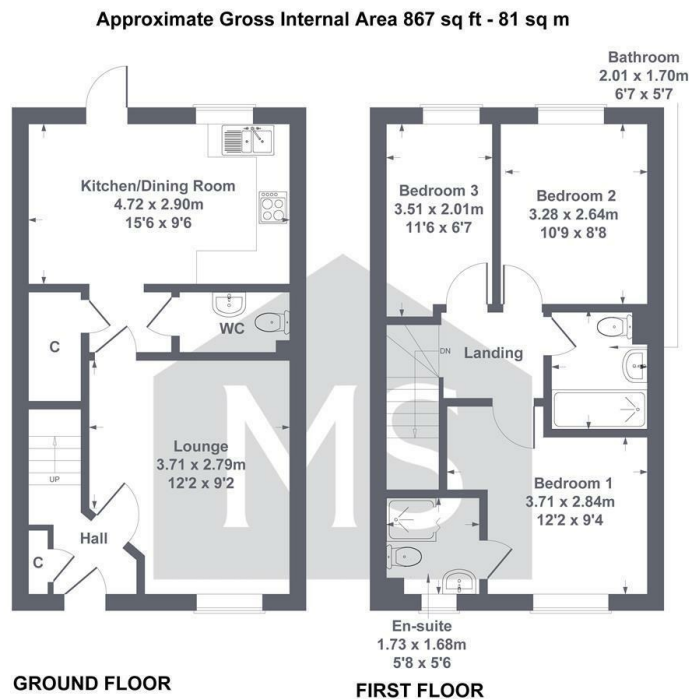

**SKETCH PLAN FOR ILLUSTRATIVE PURPOSES ONLY**

All measurements walls, doors, windows, fittings and appliances, their sizes and locations, are approximate only. They cannot be regarded as being a representation by the seller, nor their agent.

Produced by Potterplans Ltd. 2024

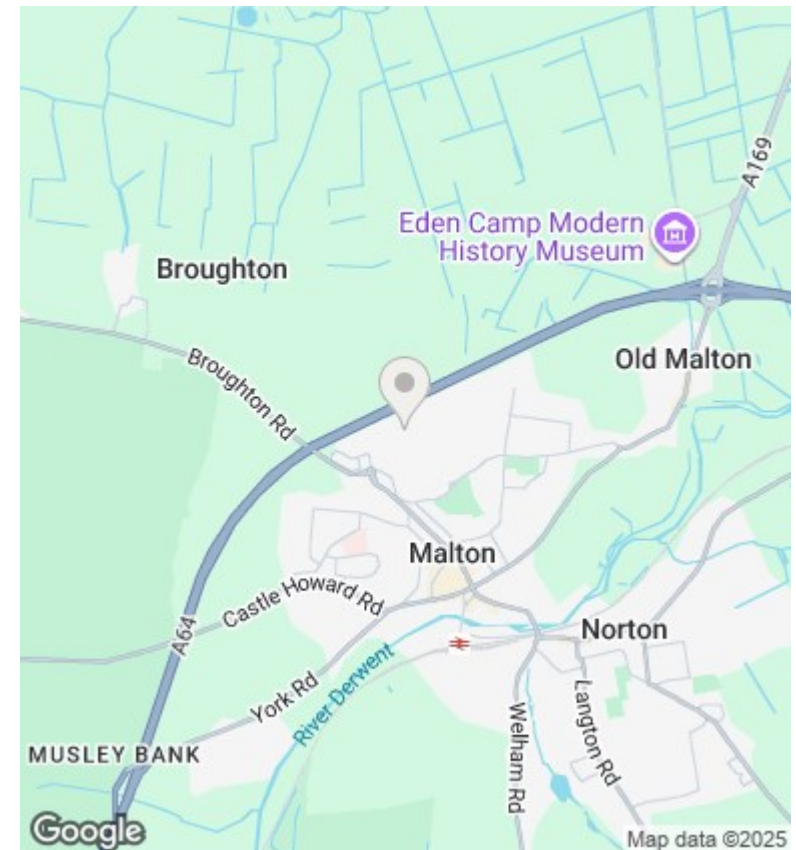

## Directions

## Viewings

Viewings by arrangement only. Call 01653 692500 to make an appointment.

## Council Tax Band

## EPC Rating:

B

Energy Efficiency Rating		
	Current	Potential
Very energy efficient - lower running costs		
(92 plus) <b>A</b>		
(81-91) <b>B</b>	82	
(69-80) <b>C</b>		
(55-68) <b>D</b>		
(39-54) <b>E</b>		
(21-38) <b>F</b>		
(1-20) <b>G</b>		
Not energy efficient - higher running costs		
<b>England &amp; Wales</b>	EU Directive 2002/91/EC	